



## **TORRINGTON PARK, FINCHLEY**

**LONDON, N12 9LL**

**£2,500 PER MONTH**

A beautifully presented three-bedroom ground floor residence set within a charming and well-kept development, right in the heart of North Finchley. This elegant home offers bright, well-balanced interiors with a seamless flow between living and dining spaces, ideal for both relaxing and entertaining.

The property is thoughtfully arranged, featuring generously sized bedrooms, a well-appointed kitchen, and access to a private outdoor area that adds a rare touch of tranquillity. Perfectly positioned just moments from Friary Park and the vibrant North Finchley High Road, you are surrounded by cafés, shops, and everyday essentials, while also benefiting from excellent transport links via Woodside Park Underground Station (Northern Line).

Offered fully furnished and available for long let, this is a refined and comfortable home in one of North London's most desirable locations.

**david harris & co**

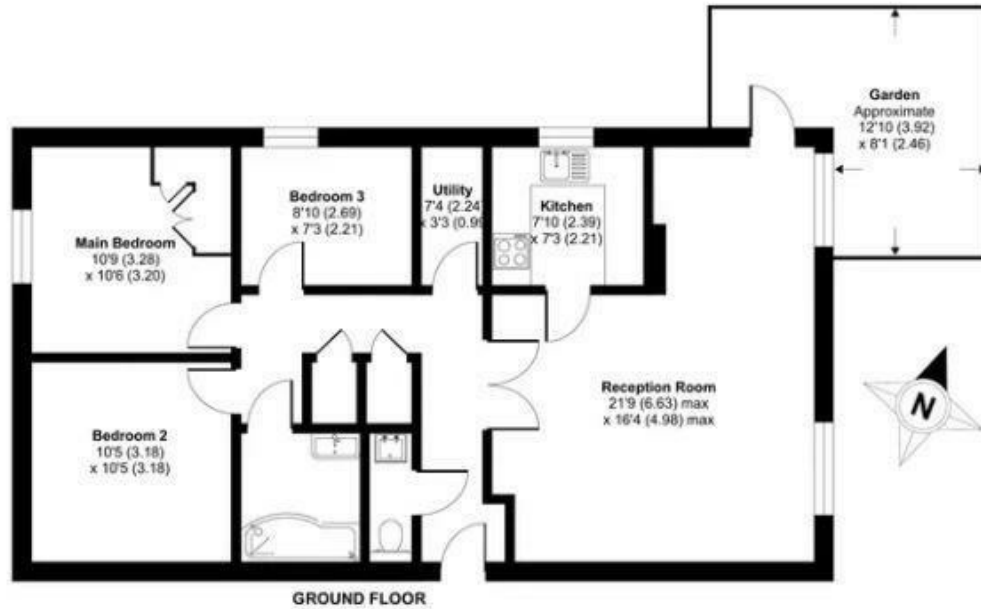

| Energy Efficiency Rating                    |                            |           |
|---|----------------------------|-----------|
|   | Current                    | Potential |
| Very energy efficient - lower running costs |                            |           |
| (92 plus) A                                 |                            |           |
| (81-91) B                                   |                            |           |
| (69-80) C                                   | 74                         | 77        |
| (55-68) D                                   |                            |           |
| (39-54) E                                   |                            |           |
| (21-38) F                                   |                            |           |
| (1-20) G                                    |                            |           |
| Not energy efficient - higher running costs |                            |           |
| <b>England &amp; Wales</b>                  | EU Directive<br>2002/91/EC |           |

Agents Note: Whilst every care has been taken to prepare these particulars, they are for guidance purposes only. All measurements are approximate and are for general guidance purposes only and whilst every care has been taken to ensure their accuracy, they should not be relied upon and potential buyers/tenants are advised to recheck the measurements

Finchley Lettings  
358 Regents Park Road  
Finchley  
London  
N3 2LJ

020 8346 9122  
info@davidharris.co.uk  
www.davidharris.co.uk

**david harris & co**